

# BAUFOIL: FOIL FACED INSULATION OVERLAY



Structural heating panel

## PRODUCT DESCRIPTION

The BAUFOIL panel system forms part of our comprehensive range of underfloor heating panel systems. This low-profile, low weight, adhesive system is ideal for retro-fit, acoustic and new build installation, particularly where floor build-up height and weight is at a premium.

The panel insulation is pre-grooved using high quality engineering tools, a foil layer reflective layer is then heat-adhered to produce an effective, high output underfloor heating panel solution. This can be used with our universal MULITOP product to give a high heat output floor finish with in-built decoupling layer ready to accept carpet, wood or tiles directly or even vinyl with additional preparation work using the RS-FLEX levelling compound in line with the vinyl manufacturers requirements.

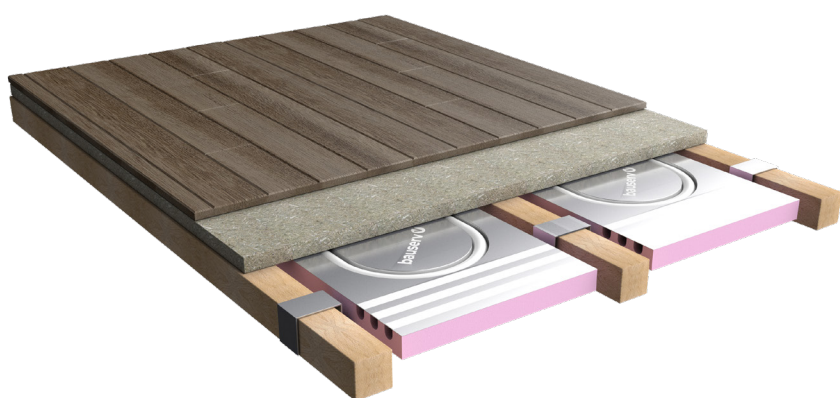

## DIMENSIONS

(Not to scale)

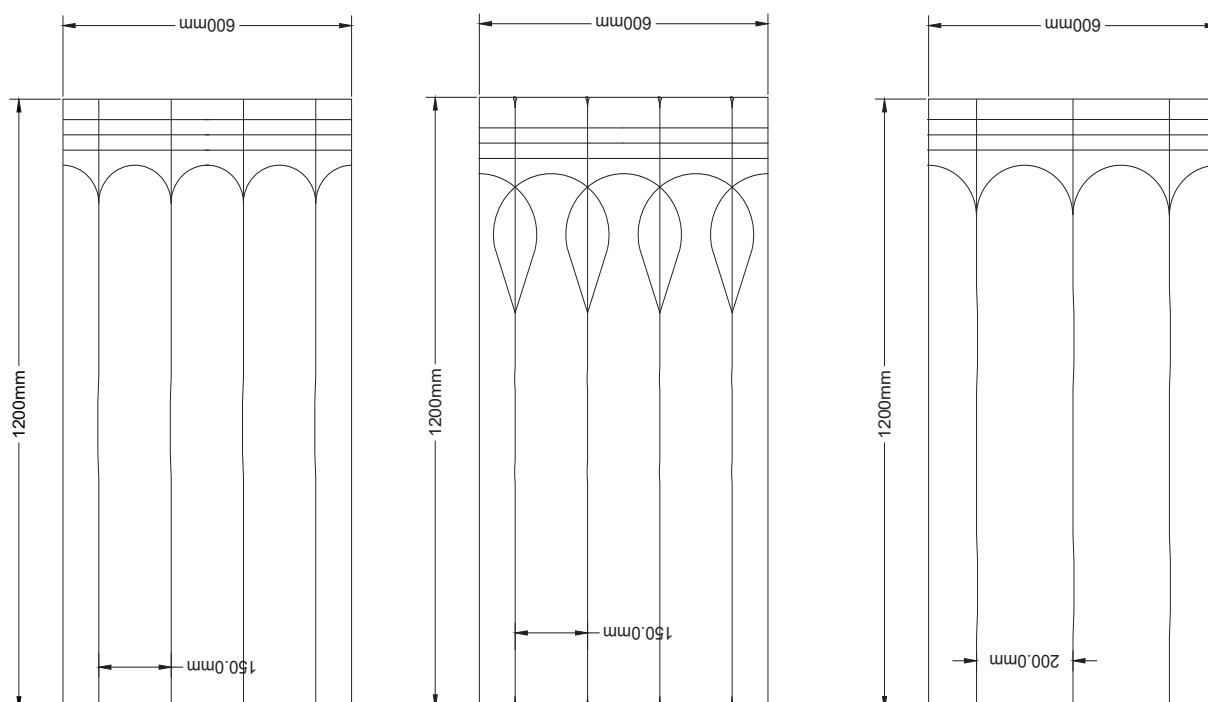

**BAUFOIL: FOIL FACED INSULATION OVERLAY**

Structural heating panel

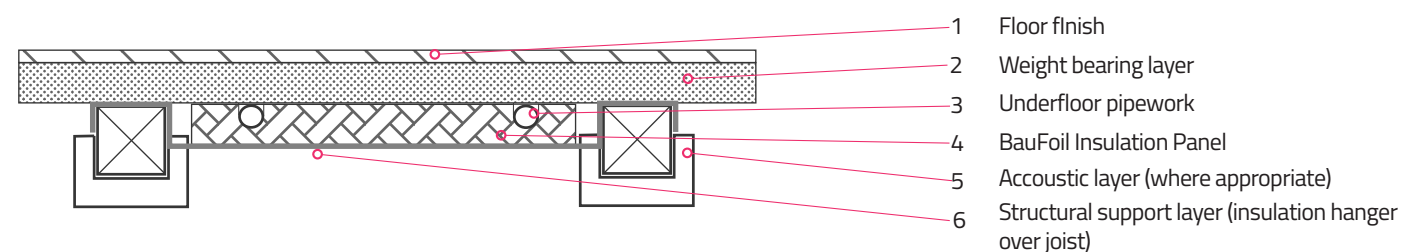
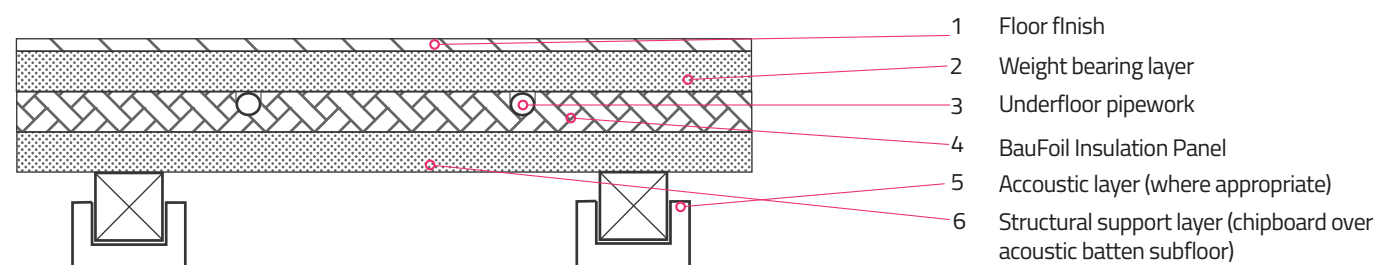
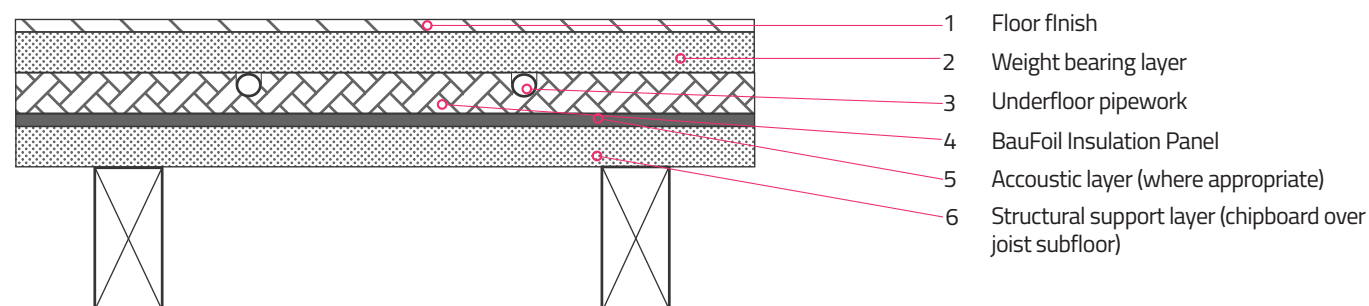
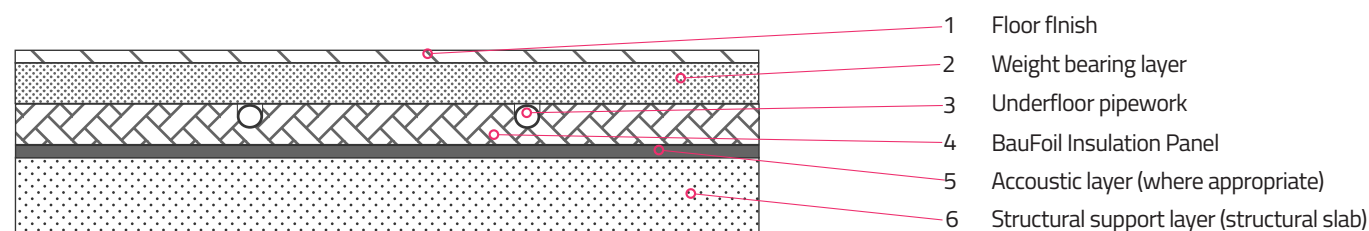
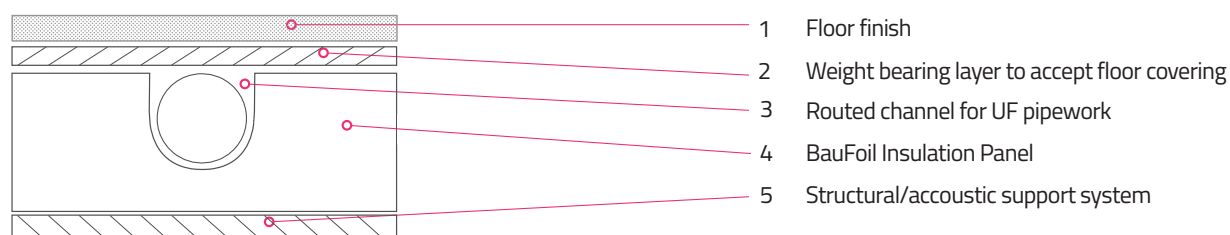
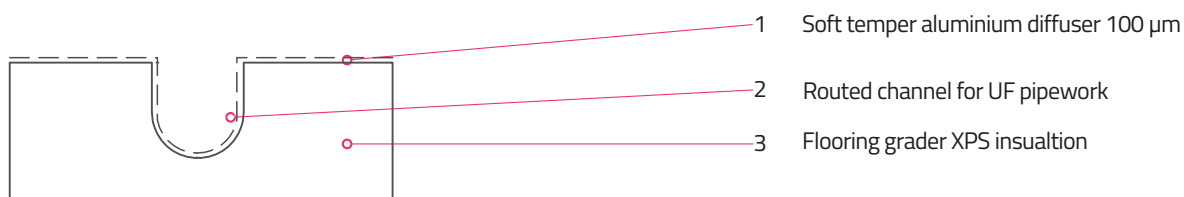
**PRODUCT SECTIONS**

**BAUFOIL: FOIL FACED INSULATION OVERLAY**

Structural heating panel

**TECHNICAL DATA**

<b>CONSTRUCTION TYPE</b>	<b>BS1264 Type A</b>
<b>WEIGHT BEARING LAYER</b>	Bauserv MultiTOP, floorboard(by others) or BAUTHERM screed
<b>WEIGHT BEARING LAYER THICKNESS</b>	MultiTOP: 0.2 W/mK Screed replacement panel: 0.38 W/mK Chipboard: 0.14 W/mK Screed: 1.4 – 2.3 W/mK
<b>WEIGHT BEARING LAYER CONDUCTIVITY</b>	4mm MultiTOP; 18mm board; 10+ levelling compound; 30mm BAUTHERM screed
<b>THERMAL DIFFUSION LAYER THICKNESS</b>	100 µm in channels, 100 µm on surface
<b>THERMAL DIFFUSION LAYER CONDUCTIVITY</b>	200 W/mK
<b>THERMAL INSULATION TYPE</b>	XPS
<b>THERMAL INSULATION CONDUCTIVITY</b>	0.033 W/mK
<b>THERMAL INSULATION GRADE</b>	200 kPA
<b>ACOUSTIC LAYER</b>	Optional
<b>INSULATION PANEL FIXING</b>	RS-BOND adhesive; screws depending on structural support
<b>STRUCTURAL SUPPORT SYSTEM</b>	Structural floorboards over support system by others Structural timber boards over floor joists by others Structural concrete (slab or beam) by others
<b>PANEL DIMENSION</b>	1200 x 600mm
<b>PANEL AVAILABLE THICKNESS</b>	18, 25, 50mm
<b>SYSTEM WEIGHT</b>	From 2.0 kg/m <sup>2</sup> with water, depending on weight bearing layer
<b>RECYCLABLE</b>	Yes

**BAUFOIL: FOIL FACED INSULATION OVERLAY**

Structural heating panel

**HEATING PERFORMANCE** DRT = 20degC, 1.0 Tog covering per BS1264-3

BauFoil using 4mm 0.16 W/mK MULTITOP

Pipe size	Pipe spacing	Heat output* W/m <sup>2</sup> @ 60/50 1.0 tog	Heat output* W/m <sup>2</sup> @ 55/45 1.0 tog	Heat output* W/m <sup>2</sup> @ 45/38 1.0 tog	Heat output* W/m <sup>2</sup> @ 35/29 1.0 tog
12 x 1.4	150	96	82	58	30
12 x 1.4	200	82	70	50	26
16 x 2	150	99	84	59	31
16 x 2	200	86	73	52	27

\* Heat Outputs:

1. Based on effective heated foil area.
2. Based on design room temperature of 21°C.
3. Shown using a 1.0 TOG default floor covering per BS1264-3.
4. Will increase/decrease depending on the floor covering used.
5. Will vary on final floor construction installed.

BauFoil using 18mm 0.38 W/mK screed replacement panel

Pipe size	Pipe spacing	Heat output* W/m <sup>2</sup> @ 60/50 1.0 tog	Heat output* W/m <sup>2</sup> @ 55/45 1.0 tog	Heat output* W/m <sup>2</sup> @ 45/38 1.0 tog	Heat output* W/m <sup>2</sup> @ 35/29 1.0 tog
12 x 1.4	150	87	74	52	27
12 x 1.4	200	76	65	45	24
16 x 2	150	89	76	54	28
16 x 2	200	78	66	47	24

BauFoil using 18mm 0.13 W/mK chipboard panel

Pipe size	Pipe spacing	Heat output* W/m <sup>2</sup> @ 60/50 1.0 tog	Heat output* W/m <sup>2</sup> @ 55/45 1.0 tog	Heat output* W/m <sup>2</sup> @ 45/38 1.0 tog	Heat output* W/m <sup>2</sup> @ 35/29 1.0 tog
12 x 1.4	150	61	52	36	19
12 x 1.4	200	53	45	32	16
16 x 2	150	63	53	38	20
16 x 2	200	55	46	33	17

BauFoil using 30mm 2.3 W/mK BAUTHERM Screed

Pipe size	Pipe spacing	Heat output* W/m <sup>2</sup> @ 60/50 1.0 tog	Heat output* W/m <sup>2</sup> @ 55/45 1.0 tog	Heat output* W/m <sup>2</sup> @ 45/38 1.0 tog	Heat output* W/m <sup>2</sup> @ 35/29 1.0 tog
12 x 1.4	150	106	90	63	33
12 x 1.4	200	93	79	56	29
16 x 2	150	108	92	65	34
16 x 2	200	95	81	57	30

The information on this datasheet is based on extensive experience, is intended to convey the best of our knowledge, is not legally binding and does neither constitute a contractual legal relationship nor a subsidiary obligation resulting from the bill of sale. The quality of our materials is guaranteed within the framework of our general terms and conditions. Our products may be used by professionals and/or experienced and accordingly technically skilled persons only. Users are not released from inquiring in case of uncertainties or from rendering professional workmanship. We recommend using a test surface first or a small area for initial, small-scale testing. Naturally, it is not possible to describe or foresee all possible current and future uses and peculiarities. Information that is assumed to be familiar to experts has been omitted. Please observe the current, technical, national and European standards, guidelines and data sheets regarding materials, substrates and the subsequent construction. Please contact us if you have any reservations or doubt. This version is rendered invalid if a new version is released. The most recent data sheets, safety data sheets and the terms and conditions are available from Bauserv Limited.