

BAUSLIM - LOW SCREED INSULATED

Structural heating panel

PRODUCT DESCRIPTION

The BAUSLIM system forms part of our comprehensive range of underfloor heating panel systems. This low height levelling/screed insulation system is cost effective and ideal for new build installation or laid over existing structural floors.

BAUSLIM panels are an extruded polystyrene (XPS) insulation panel which is provided pre-primed and with a self-adhesive backing to eliminate the panel 'lifting' when the pipe is installed. With a multi-directional pipe channel pattern to accept the underfloor pipework, the pipework is held within the depth of the insulation layer (so that the surface of the pipe does not sit higher than the surface of the insulation) allowing minimum levelling compound or screed depths to be optimally achieved. To ensure best heat outputs a 'diffuser channel' is also built into the panel ensuring good thermal transfer from the pipe to the levelling screed.

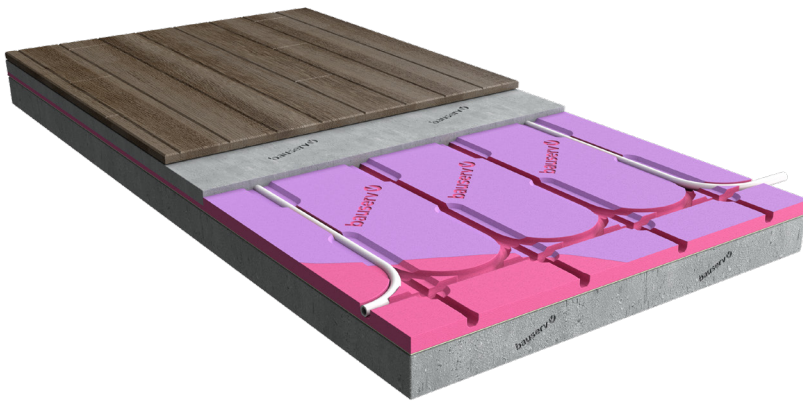

PRODUCT SECTIONS

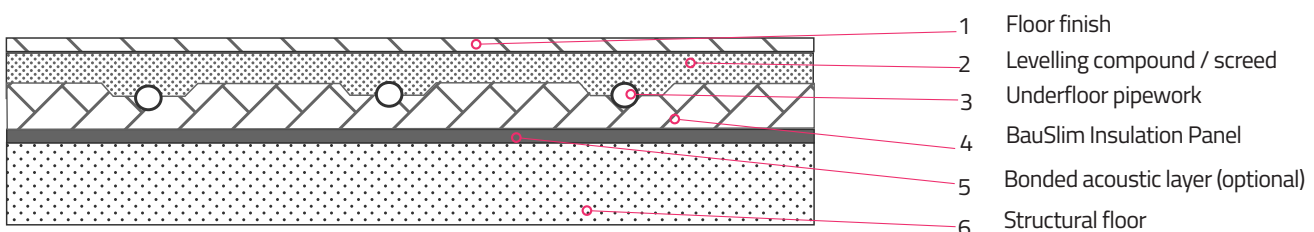
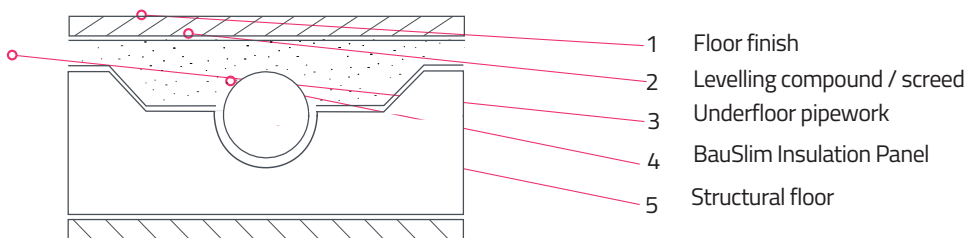
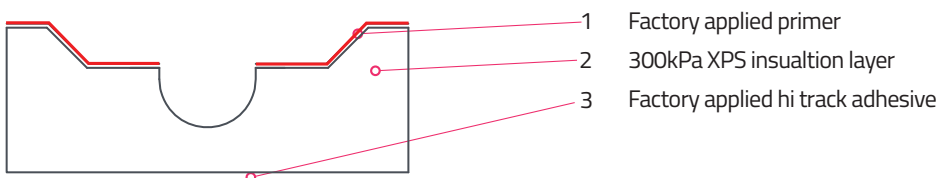

BAUSLIM - LOW SCREED INSULATED

Structural heating panel



TECHNICAL DATA

CONSTRUCTION TYPE	Floating floor panel and screed
WEIGHT BEARING LAYER	BauFlex levelling or proprietary screed
WEIGHT BEARING LAYER THICKNESS	Varies on pipe diameter, castellated panels and screed type Minimum 7mm cover over pipe/panel – RS-FLEX Minimum 25mm cover over pipe/panel – liquid screeds. Minimum 35mm cover over pipe/panel – sand/Cement screeds
WEIGHT BEARING LAYER CONDUCTIVITY	Typically, 1.2 W/mK, up to 2.3 W/mK
PIPE FIXING METHOD	Grooved channels for 12mm pipework
THERMAL DIFFUSION LAYER THICKNESS	Same weight bearing layer
THERMAL DIFFUSION LAYER CONDUCTIVITY	Same weight bearing layer
THERMAL INSULATION TYPE	XPS (extruded polystyrene)
THERMAL INSULATION CONDUCTIVITY	0.036 W/mK
THERMAL INSULATION GRADE	300kPA
INSULATION PANEL FIXING	Self adhesive - factory applied adhesive
ACOUSTIC LAYER	Optional
STRUCTURAL LAYER	Structural floorboards over support system by others. Timber boards over floor joists by others. Structural concrete: slab or beam by others.
PANEL DIMENSION	1200 x 600mm
PANEL AVAILABLE THICKNESS	18.25mm
SYSTEM WEIGHT	Varies

HEATING PERFORMANCE DRT = 21°C, 1.0 Tog covering per BS1264-3

BauSlim

Pipe size	Pipe spacing	Heat output* W/m ² @ 60/50 1.0 tog	Heat output* W/m ² @ 55/45 1.0 tog	Heat output* W/m ² @ 45/38 1.0 tog	Heat output* W/m ² @ 35/29 1.0 tog
12 x 1.4	150	85	73	54	28

* Heat Outputs:

1. are indicative for comparison purposes
2. are based on design room temperature of 21°C
3. are based on effective heated area
4. will vary on foiled area around pipe bends
5. will increase/decrease depending on the floor covering and weight bearing layer used
6. will vary on final floor construction installed.

The information on this datasheet is based on extensive experience, is intended to convey the best of our knowledge, is not legally binding and does neither constitute a contractual legal relationship nor a subsidiary obligation resulting from the bill of sale. The quality of our materials is guaranteed within the framework of our general terms and conditions. Our products may be used by professionals and/or experienced and accordingly technically skilled persons only. Users are not released from inquiring in case of uncertainties or from rendering professional workmanship. We recommend using a test surface first or a small area for initial, small-scale testing. Naturally, it is not possible to describe or foresee all possible current and future uses and peculiarities. Information that is assumed to be familiar to experts has been omitted. Please observe the current, technical, national and European standards, guidelines and data sheets regarding materials, substrates and the subsequent construction. Please contact us if you have any reservations or doubt. This version is rendered invalid if a new version is released. The most recent data sheets, safety data sheets and the terms and conditions are available from Bauserv Limited.